



**专业涂装设备制造商**  
**PROFESSIONAL COATING LINE**  
**MANUFACTURER**



**长兴华锐机械设备有限公司**  
CHANGXING HUARUI MECHANICAL EQUIPMENT CO., LTD.

Tel: 0572-6068610    Web: [www.cxhuarui.com](http://www.cxhuarui.com)  
Add: Hongqiao Industry Zone, Huzhou City, Zhejiang, China

**长兴华锐机械设备有限公司**  
CHANGXING HUARUI MECHANICAL EQUIPMENT CO., LTD.

# 目录

## CATALOGUE

### 公司简介

COMPANY INTRODUCTION

01-02

### 产品简介

PRODUCT INTRODUCTION

03-04

### 前处理设备

PRETREATMENT EQUIPMENT

05-06

### 水分烘干设备

DRYING EQUIPMENT

07-08

### 喷涂系统设备

COATING EQUIPMENT

09-10

### 涂层固化设备

CURING EQUIPMENT

11

### 悬链系统设备

CONVEYOR SYSTEM

12

### 其他展示

OTHERS

13-16

### 废气与废水设备

EXHAUST GAS & WASTEWATER EQUIPMENT

17-18

### 数字化涂装系统

DIGITAL COATING SYSTEM

19



# 公司简介

## COMPANY INTRODUCTION

长兴华锐机械设备有限公司2007年成立于湖州市长兴县，坐落于长兴县洪桥镇工业开发区，通过质量ISO9001、环境ISO14001、职业健康安全ISO45001认证。一家集科研开发，设计，生产，销售及服务为一体的，专业提供各类涂装设备商。主营：粉末喷涂线，油漆线，高温不粘喷涂线及前处理清洗线等各类涂装设备。

Changxing Huarui Mechanical Equipment Co., Ltd. is found in 2007, which located in Hongqiao Industry Zone, Huzhou City, Zhejiang Province. Has passed the quality ISO9001, environmental ISO14001, occupational health and safety ISO45001 certification. It is specialized in all kinds surfacing treatment equipment for industrial painting of plastic metal or wood items. Huarui provide a complete service which including design, develop, manufacture, installation and commissioning accompanying long time quality assurance. Main products: powder coating line, liquid coating line, NS coating line and pretreatment washing line etc.



# 资质证书

## QUALIFICATION CERTIFICATE

长兴华锐机械设备有限公司自2016年获得浙江省高新技术企业，并长期致力于新技术的开发，获得了多项发明专利；

Changxing Huarui Mechanical Equipment Co., Ltd. has been awarded as a high-tech enterprise in Zhejiang Province since 2016, and has been committed to the development of new technologies and obtained a number of invention patents.





# 产品简介

## PRODUCT INTRODUCTION

华锐机械提供各类完整的油漆和粉末喷涂生产线，设备包含前处理、喷房、烘干炉、固化炉、输送设备及通风系统等必要的工艺要求；同时还可根据客户提供恒温恒湿等工艺；

Huarui Mechanical Equipment all kinds liquid coating & powder coating lines are supplied as a complete delivery including all the necessary process;



### • 涂装生产线基本构成

The Basic Composition of Coating Flow Production Line

#### 前处理设备

清洗及表面干燥  
Pretreatment

#### 喷涂设备

依据产品特性一次或多次喷漆  
Paint application

#### 低温烘干设备

Flash off

#### 高温固化设备

Drying and Curing ovens

#### 工件输送系统

Conveyor

#### 废气挥发系统

Ventilating system

#### 控制系统

Control system

#### 配套辅助设备

Loading & unloading system

另外更多的要求，例如准确的温度和湿度控制等，都按客户工艺而定。

Furthermore, any other requirements such as accurate temperature and humidity control can be included as customer request.

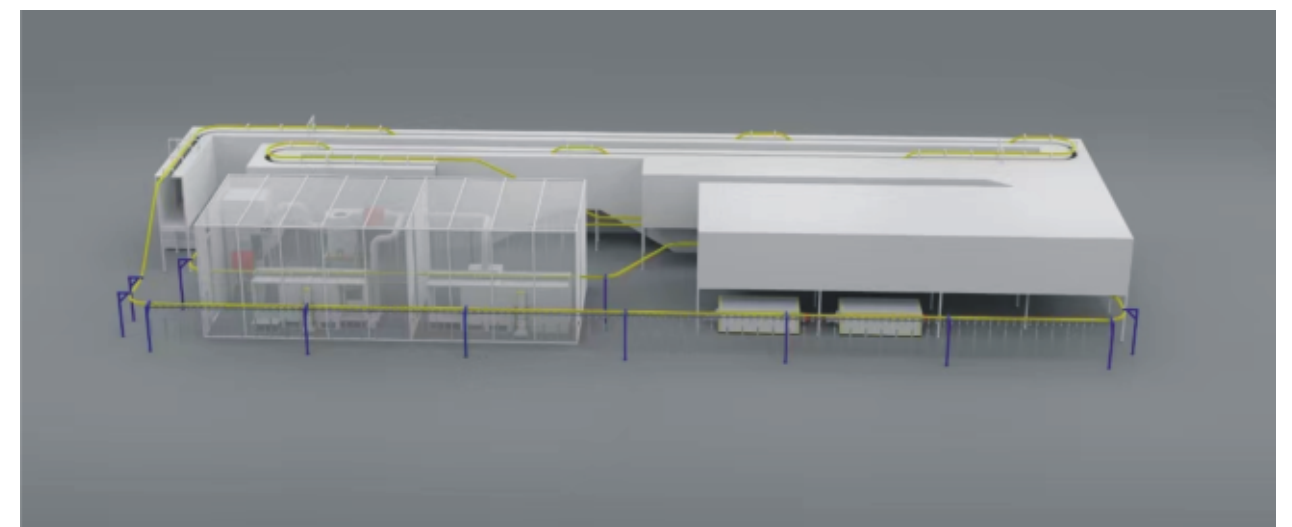



# 前处理设备

## PRETREATMENT EQUIPMENT

### • 喷淋式前处理

适用于尺寸较小，品种单一，工件表面死角。

### • Spray Pretreatment

It is suitable for workpieces with small size, single variety and few dead comers on the workpiece surface.

### • 游浸式前处理

适用于工件表面死角多，难以喷淋的工件，可以适当增加超声波清洗装置。

### • Immersion Pretreatment

It is suitable for workpieces with many dead comers on the workpiece surface and difficult to spray. Ultrasonic cleaning device can

### • 槽浸前处理

适用于产品结构复杂，品种多,尺寸大，屏蔽面多的工件宜浸渍前处理。

### • Dipping Pretreatment

It is applicable to the workpiece with complex product structure, many varieties, large size and many shielding surfaces, which should be treated before impregnation.



游浸式前处理

Swimming immersion pretreatment



喷淋式前处理

Automatic dosing system



自动吹水系统

Air curtain



纯水设备

DI Water system



袋式过滤器

Bag filter



前处理喷淋内景

Tank Dipping pretreatment



台式前处理

Desktop pretreatment



槽浸式前处理

Bath immersion pretreatment



# 水份烘干设备

DRYING EQUIPMENT

用于对已完成清洗工作，表面残留水份的工件进行烘干。

It is used for cleaning the workpiece, residual water on the surface, and drying the surface water of the workpiece

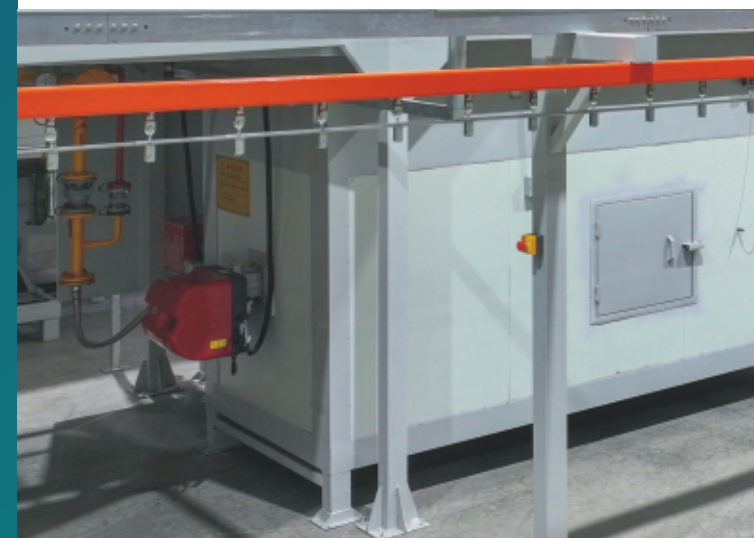

加热室  
Heating chamber

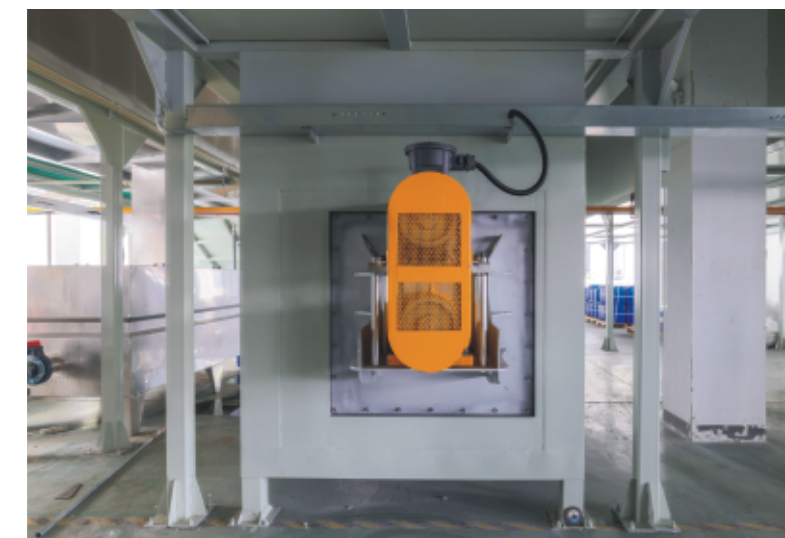

插入式循环风机  
Plug in circulating fan



水份烘干炉  
Drying Oven



烘干烘道  
Drying tunnel



# 喷涂系统设备

COATING EQUIPMENT



干式喷漆  
Dry painting



水帘式喷漆  
Water curtain painting



机器人喷涂  
Robot painting



喷粉房  
Powder spray booth



往复机喷涂  
Reciprocator painting



喷粉房  
Powder spray booth



喷粉生产线  
Powder coating line



## 涂层固化设备 CURING EQUIPMENT

用于对工件进行过喷粉（漆）、电泳之后的工件提供高（低）温固化。

It is used to provide high (low) temperature curing for the workpiece after powder (paint) spraying and electrophoresis.



## 悬链系统设备 CONVEYOR SYSTEM

悬挂输送机由驱动装置、张紧装置、变频调速器、链条、直轨、弯轨、温度伸缩轨、检查轨和润滑装置等组成。

The suspension conveyor is composed of driving device, tensioning device, frequency converter, chain, straight rail, curved rail, temperature telescopic rail, inspection rail and lubrication device.



**地轨链输送**  
Ground rail conveyor



**积放链输送**  
Power & free Conveyor



**重型悬挂链输送**  
Heavy conveyor



**龙门行车输送**  
Gantry conveyor system



## 其他展示

OTHER PRESENTATIONS



输送系统  
Conveyor



喷粉设备  
Powder coating



喷粉设备  
Powder coating



电泳线  
Electrophoretic coating line



固化炉热室  
Curing oven



烘干设备  
Drying oven



热风循环设备  
Heated air circulation



喷粉设备  
Powder coating system



超声波设备  
Ultrasonic system



## 其他展示

OTHER PRESENTATIONS



喷漆房操作通道  
Operating walk way



固化后冷却设备  
Cooling system



上下工件装置  
Uploading & downloading



喷粉及固化设备  
Powder coating system



喷涂辅助设备  
Auxiliary equipment



抛丸设备  
Shot blasting MC



纯水设备  
DI water MC



喷粉设备  
Powder coating system



喷粉设备  
Powder coating system



# 废气与废水

EXHAUST GAS & WASTE WATER

催化燃烧生产设备产生的有机废气经过过滤装置将废气中的颗粒物隔除，并经过热交换器降温后再送到活性炭吸附床根据风量确定活性炭吸附床数量，当吸附床废气达到饱和量时，脱附催化开始工作确保废气进入催化床的预热器。废气经过加热，燃烧，被分解为二氧化碳和水，从而达到净化效果。

CATALYTIC COMBUSTION: The organic waste gas from the production equipment is separated from the waste gas by a filtering device, cooled by a heat exchanger and then sent to an activated carbon adsorption bed, when the adsorption bed exhaust gas reaches saturation, the desorption catalyst starts to work to ensure that the exhaust gas enters the preheater of the catalytic bed. The exhaust gas is heated, burned, and broken down into carbon dioxide and water for purification.



废水处理

Waste water treatment



废水处理

Waste water treatment



废气处理

Waste gas treatment



废气处理

Waste gas treatment

# PMS-SA标准方案

STANDARD PLAN

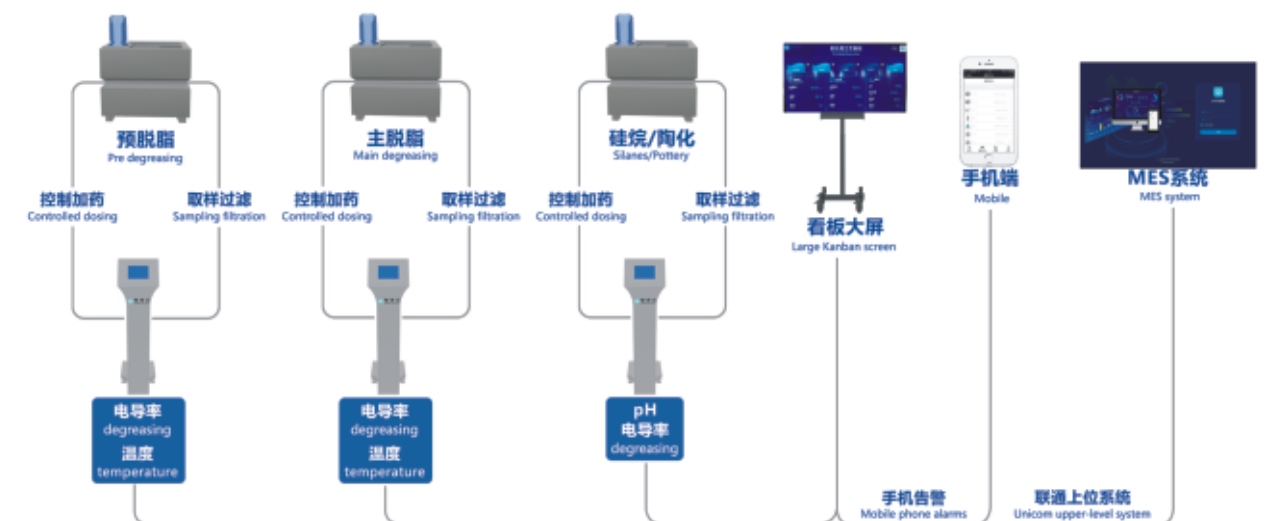
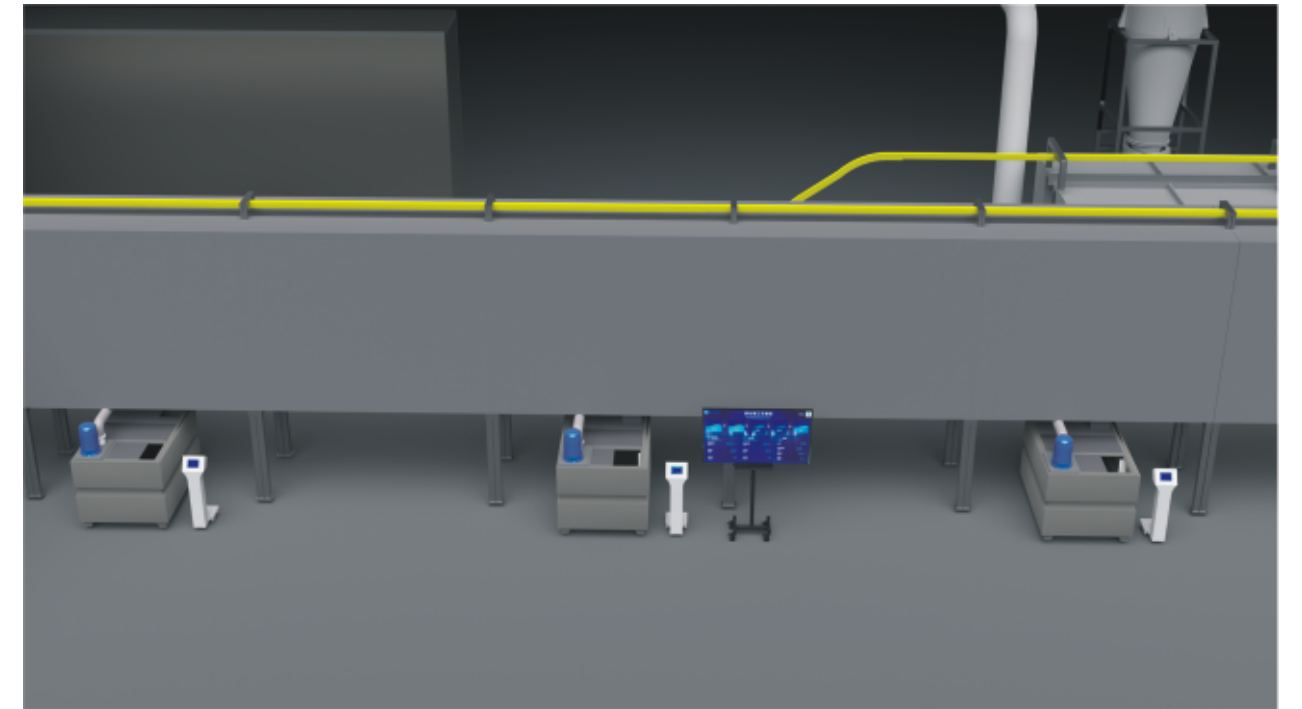

# 数字化涂装系统

DIGITAL COATING SYSTEM

## • 系统概述

System Overview

CoatLink-MES

